

Non-Contact Infrared Thermometer Quick Start Guide

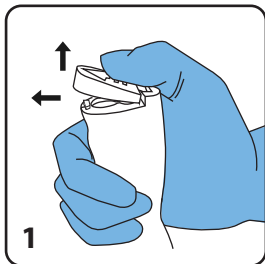

Step One: Push in the direction of the printed arrow and lift up the bottom battery cover.

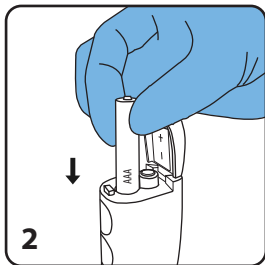

Step Two: Insert 2 AAA batteries and confirm battery orientation with the +/- signs on the metal plate.

*For detailed instructions and specifications, please scan QR code below or visit <https://www.pac-dent.com/Download-documents/Thermometer%20IFU.pdf>.



Manufactured For: Pac-Dent, Inc.
670 Endeavor Circle, Brea, CA 92821 USA
909.839.0888 www.pac-dent.com
Made in China

Continued on the back →



Step Three: Close the battery cover. You will hear a beep when the batteries are installed correctly.

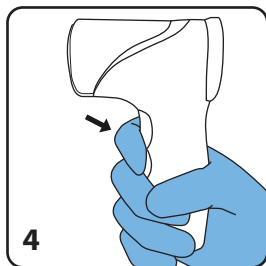

Step Four: Hold the thermometer 2-3 inches away from the target and press the trigger button to take the temperature.

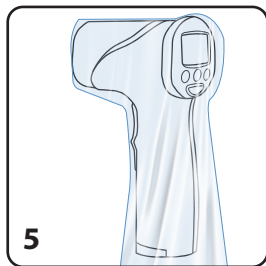

Step Five: Armor™ Disposable Infrared Thermometer Sleeves are recommended for use for high-frequency readings to prevent cross-contamination.